

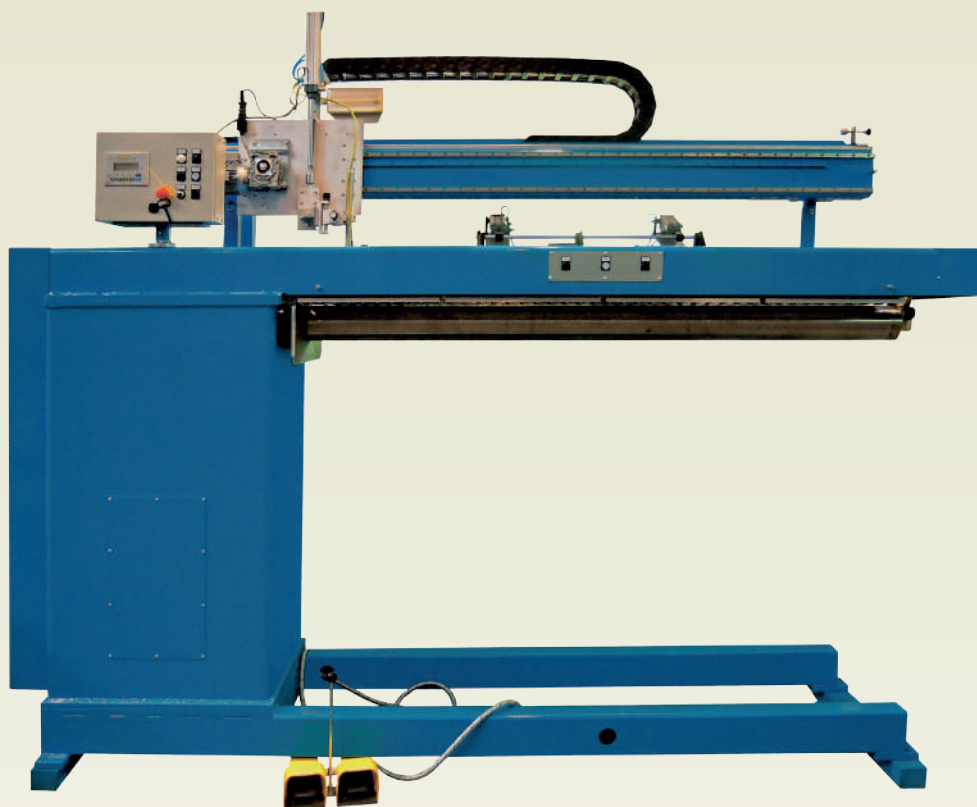

The logo for AUTOMA 2000 features the word "AUTOMA" in a bold, blue, sans-serif font. The letter "A" is stylized with a blue outline and a solid orange diagonal bar. Below the word "AUTOMA" is a thick orange horizontal bar that tapers to the right. To the right of this bar, the year "2000" is written in a smaller, orange, sans-serif font.

AUTOMA

2000

2023 CATALOG



 **DESCRIZIONE**
Banchi di bloccaggio per saldatura da 1000 a 2000 mm di lunghezza.
Tubo di appoggio con barra di supporto in lega di rame; barra, con raffreddamento ad acqua fori di insufflaggio gas.
Centratore longitudinale pneumatico.
Gli SBR sono forniti in versione TIG/MIG/Plasma.

 **DESCRIPTION**
Welding clamping benches from 1000 to 2000 mm in length.
Support tube with copper alloy support bar; bar, water-cooled gas blow-out holes.
Pneumatic longitudinal centring device.
SBRs are supplied in TIG/MIG/Plasma version.

 **BESCHREIBUNG**
Schweißspanntische mit einer Länge von 1000 bis 2000 mm.
Tragrohr mit Tragstange aus Kupferlegierung; Stange, wassergekühlte Gasausblasöffnungen.
Pneumatische Längszentriervorrichtung.
SBRs werden in der Version TIG/MIG/Plasma geliefert.

 **DESCRIPTION**
Bancs de soudage de 1000 à 2000 mm de longueur.
Tube support avec barre de support en alliage de cuivre ; barre, trous de soufflage de gaz refroidis à l'eau.
Dispositif pneumatique de centrage longitudinal.
Les SBR sont fournis en version TIG/MIG/Plasma.

 **DESCRIPCIÓN**
Bancos de bloqueo para soldadura de 1000 a 2000 mm de longitud.
Tubo de soporte con barra de soporte de aleación de cobre; barra, orificios de soplado de gas refrigerados por agua.
Centrador longitudinal neumático.
Los SBR se suministran en versión TIG/MIG/Plasma.

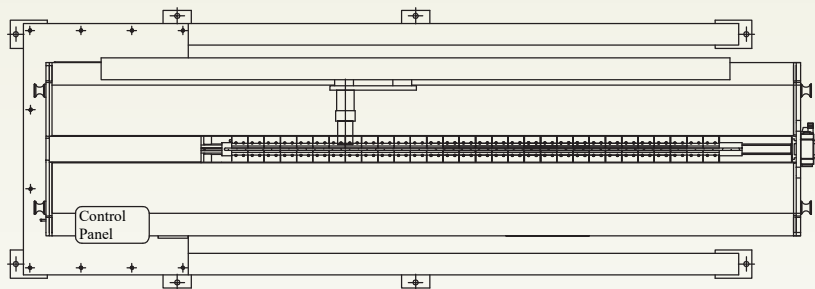
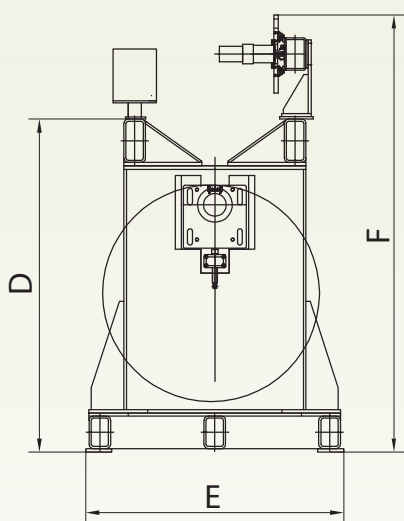
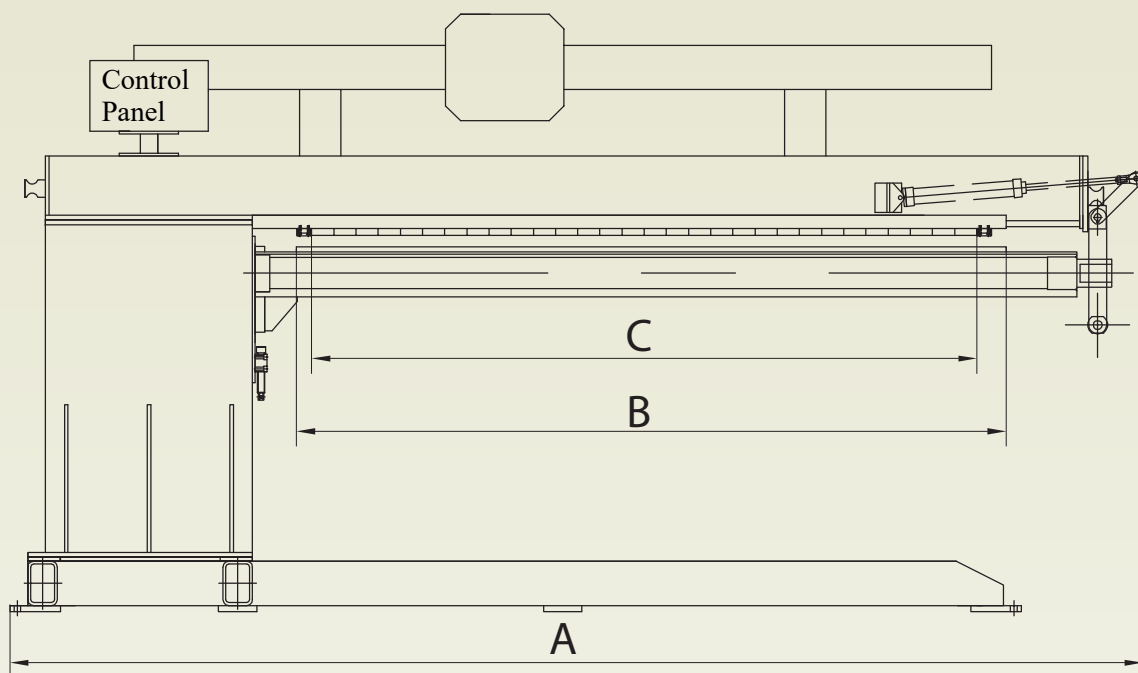



Dati/Data/Donnes/ Daten/Datos	L1 mm	Dmin mm	Dmax mm	mm/1	Spessore/ Thickness	A	B	C	D	E	F	volt	volt	LxWxH	kg
SBR 1000 I PLC	1000	120	1000	100-1000	0,8-5	2857	1425	1275	1536	1190	2016	1x220	24	2857x1190x2016	1900
SBR 2000 I PLC	2000	120	1000	100-1000	0,8-5	3832	2400	2250	1536	1190	2016	1x220	24	3832x1190x2016	2435

SBR BRUSHLESS

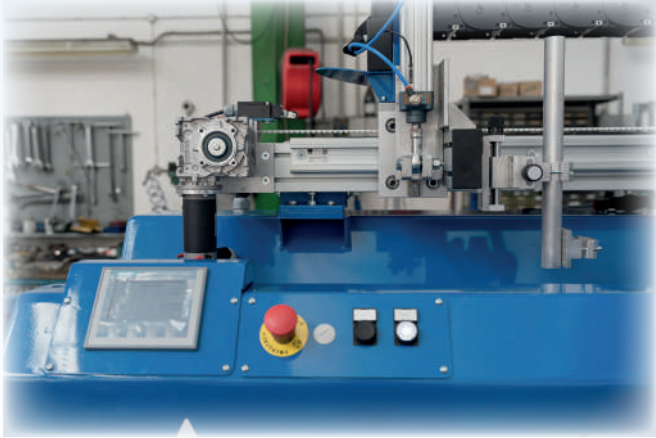
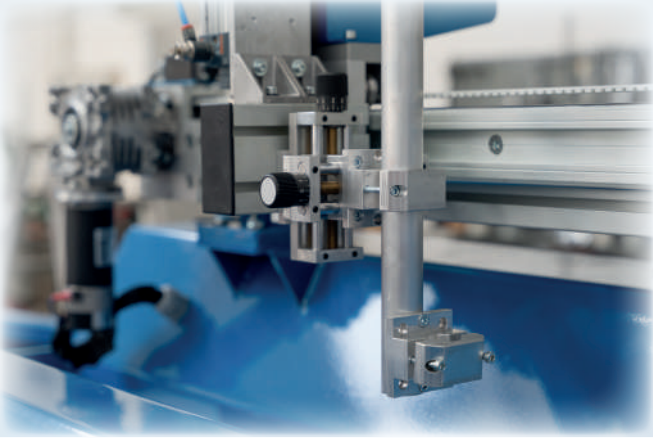
SBR BRUSHLESS



 **DESCRIZIONE**
 Struttura portante in acciaio elettrosaldato, trave con incorporata barra di rame in Cu-Cr-Zr, predisposizione raffreddamento barra di rame, carrello completo di supporto torcia con svincolo pneumatico, sistema pneumatico di chiusura anteriore, dispositivo di centraggio lineare ad azionamento pneumatico, quadro di controllo per gestione ciclo saldatura.
 Trave in alluminio, con cinghia in teflon resistente al calore per trasmissione moto carrello. Motorizzazione del carrello porta torcia tramite motore brushless.

 **DESCRIPTION**
 Electro-welded steel support structure, beam with incorporated Cu-Cr-Zr copper bar, cooling arrangement copper bar, trolley complete with torch support with pneumatic release, pneumatic front locking system pneumatically operated linear centring device, control panel for welding cycle management.
 Aluminium beam, with heat-resistant Teflon belt for trolley motion transmission.
 Torch carriage motorisation by brushless motor.

 **BESCHREIBUNG**
 Tragkonstruktion aus elektrogeschweißtem Stahl, Träger mit eingebauter Cu-Cr-Zr-Kupferschiene, Kühlvorrichtung Kupferstange, Wagen mit Brennerhalterung mit pneumatischer Entriegelung, pneumatisches Frontverriegelungssystem pneumatisch betätigte lineare Zentriervorrichtung, Steuerpult für die Verwaltung des Schweißzyklus.
 Aluminiumträger, mit hitzebeständigem Teflonriemen für die Bewegungsübertragung des Wagens. Motorisierung des Brennerwagens durch bürstenlosen Motor.

 **DESCRIPTION**
 Structure de support en acier électrosoudé, poutre avec barre de cuivre Cu-Cr-Zr incorporée, dispositif de refroidissement barre de cuivre, chariot complet avec support de torche à déclenchement pneumatique, système de verrouillage pneumatique frontal dispositif de centrage linéaire à commande pneumatique, tableau de commande pour la gestion du cycle de soudage.
 Poutre en aluminium, avec courroie en téflon résistant à la chaleur pour la transmission du mouvement du chariot. Motorisation du chariot de la torche par moteur brushless.

 **DESCRIPCIÓN**
 Estructura de soporte de acero electrosoldado, viga con barra de cobre Cu-Cr-Zr incorporada, dispositivo de refrigeración barra de cobre, carro completo con soporte de antorcha con desbloqueo neumático, sistema de bloqueo frontal neumático dispositivo de centrado linear de accionamiento neumático, panel de control para la gestión del ciclo de soldadura.
 Viga de aluminio, con correa de teflón resistente al calor para la transmisión del movimiento del carro. Motorización del carro de la antorcha mediante motor sin escobillas.

Dati/Data/Donnes/ Daten/Datos	Dmin mm	Dmax mm	Spessore/ Thickness	volt	volt	Dimensioni/ Dimensions	Peso/Weight
SBR 600 BRUSHLESS	70	800	0,5-2	1x220	24	1600x750x1600 mm H	600 kg
SBR 1000 BRUSHLESS	70	800	0,5-2	1x220	24	2000x750x1600 mm H	700 kg
SBR 1500 BRUSHLESS	70	800	0,5-2	1x220	24	2600x750x1600 mm H	800 kg

AUTOMA 2000 s.r.l.

Via delle Albicocche, 30 - 47522 (FC) Italy
Tel. +39 0547 313347
www.automa2000.com
info@automa2000.com
P.IVA / Cod. Fisc. / Reg. Impr. 01582080352
R.E.A. FO 294946 - Cap. Soc. € 98.126,81 i.v.